

Einbauanleitung Mounting instruction Montagehandleiding Instructions de montage Istruzioni di montaggio

Poresta® Slot S

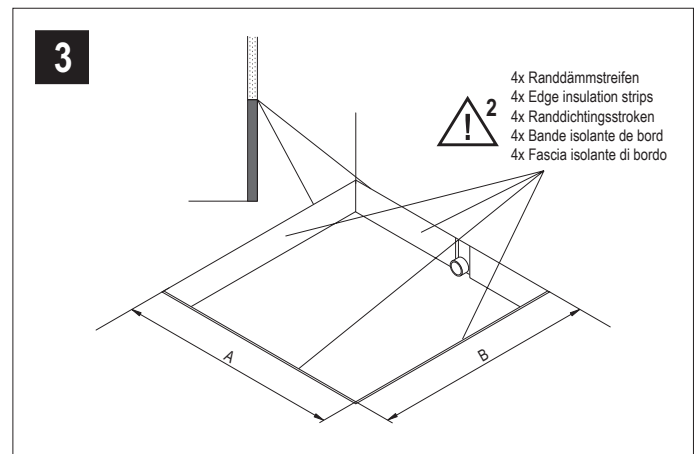
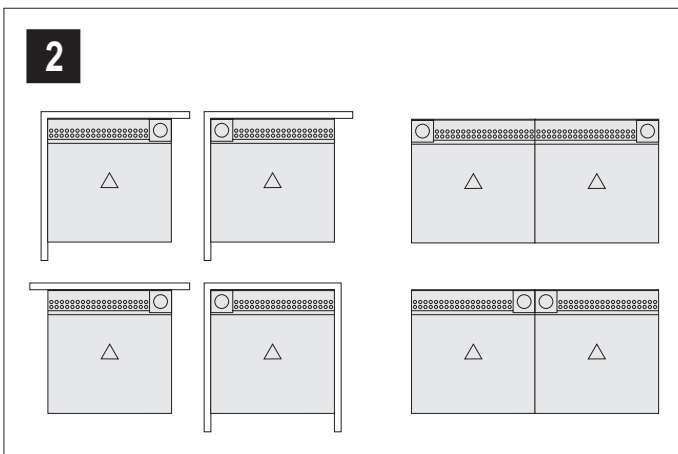
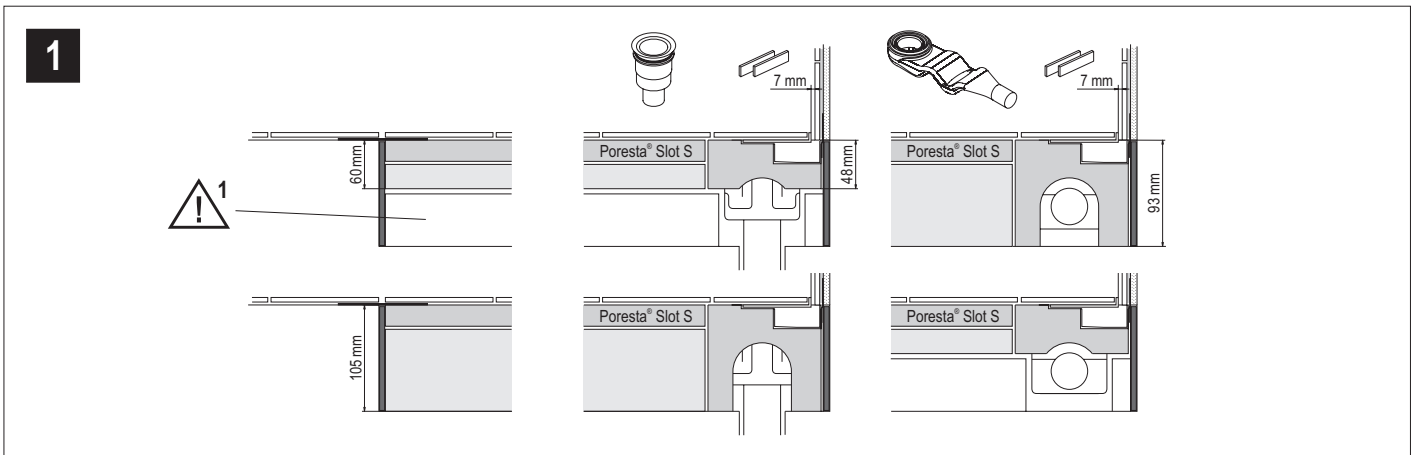
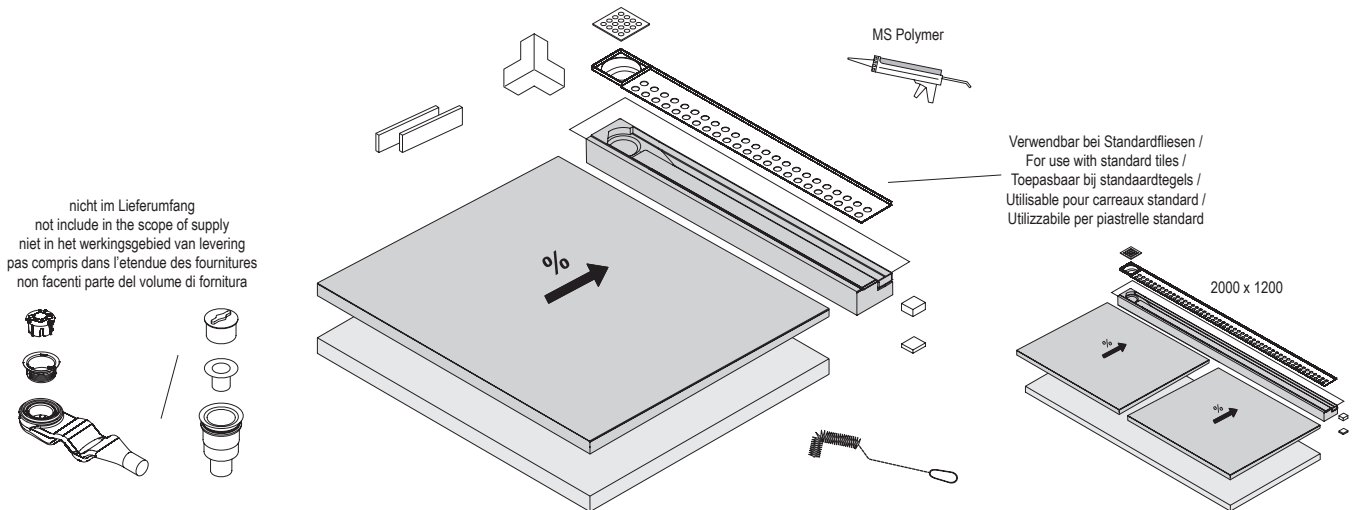

Einbauanleitung Mounting instruction Montagehandleiding Instructions de montage Istruzioni di montaggio

Poresta® Slot S

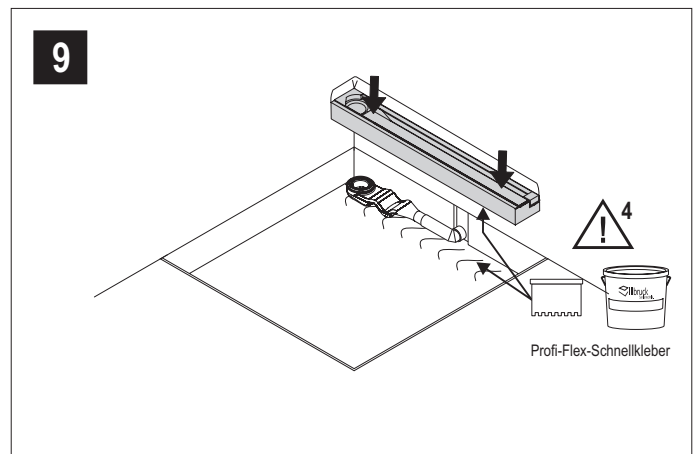
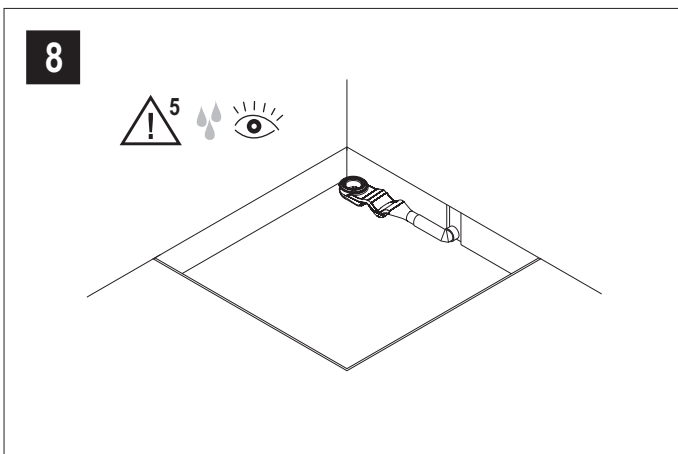
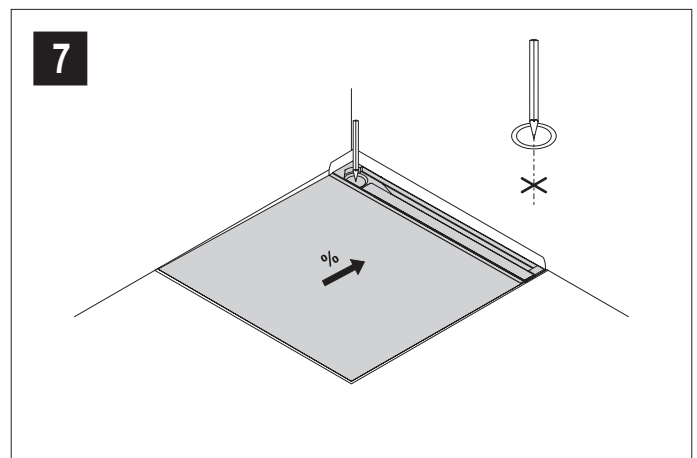
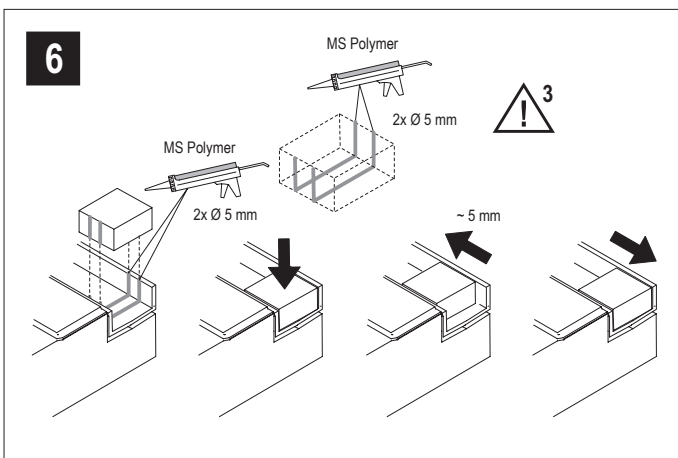
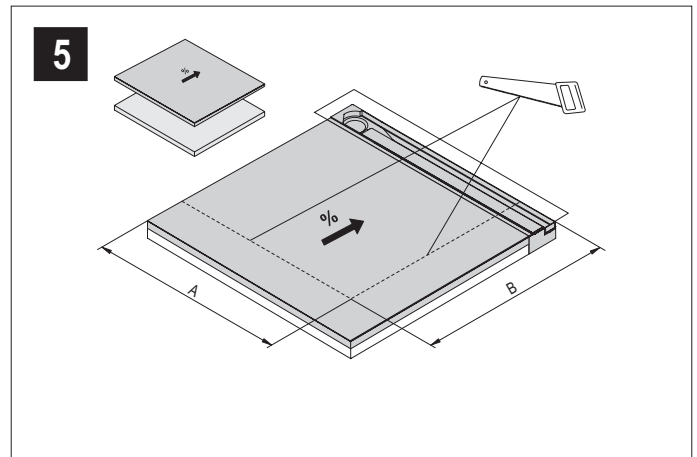
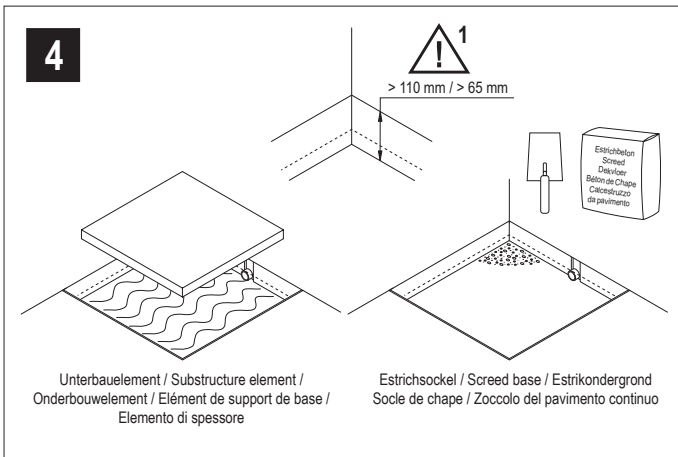

Einbauanleitung
 Mounting instruction
 Montagehandleiding
 Instructions de montage
 Istruzioni di montaggio

Poresta® Slot S

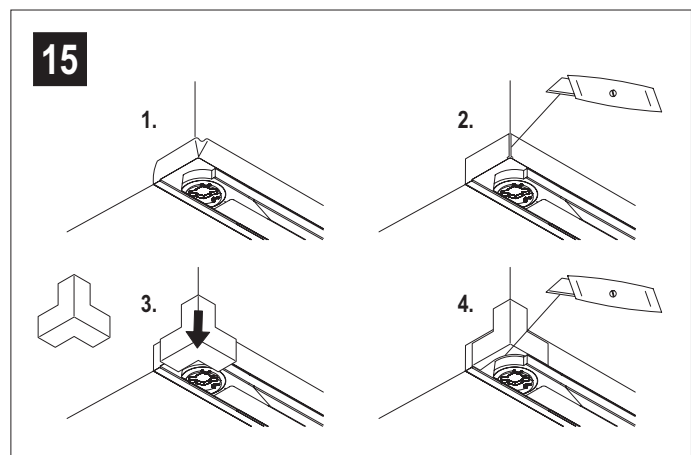
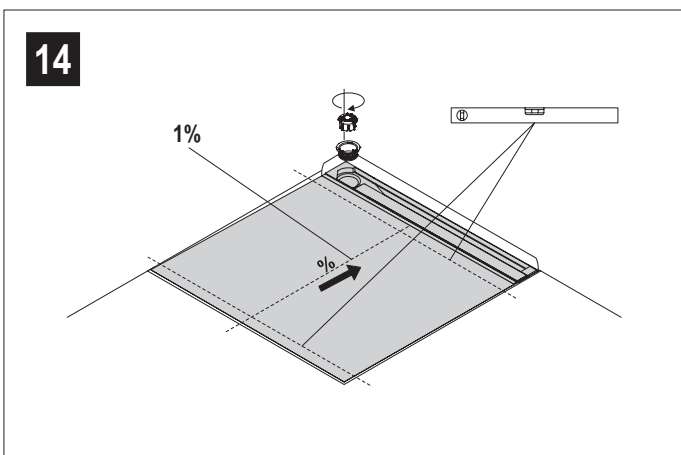
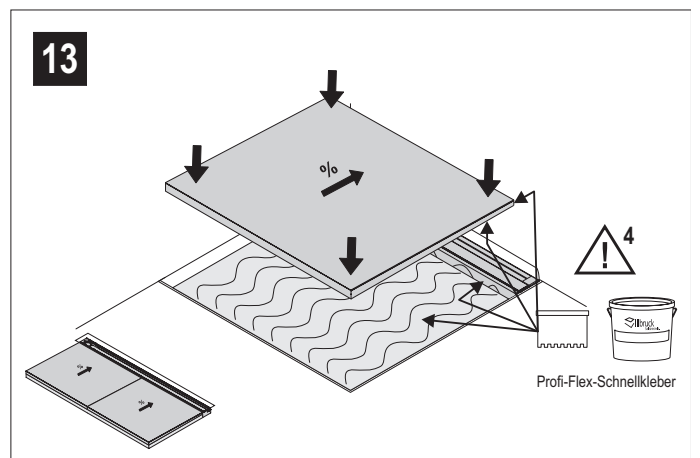
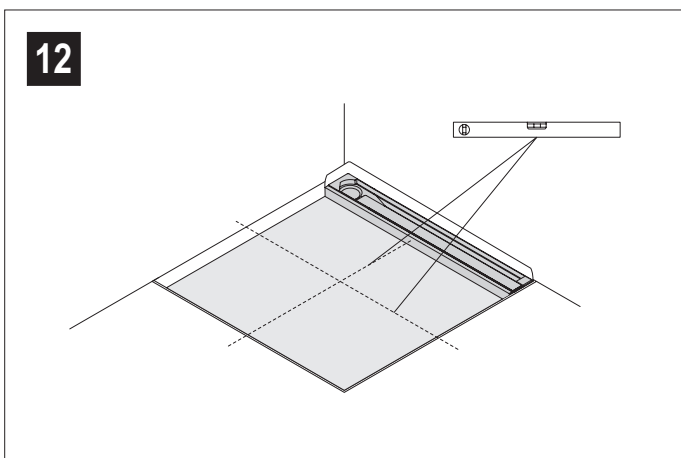
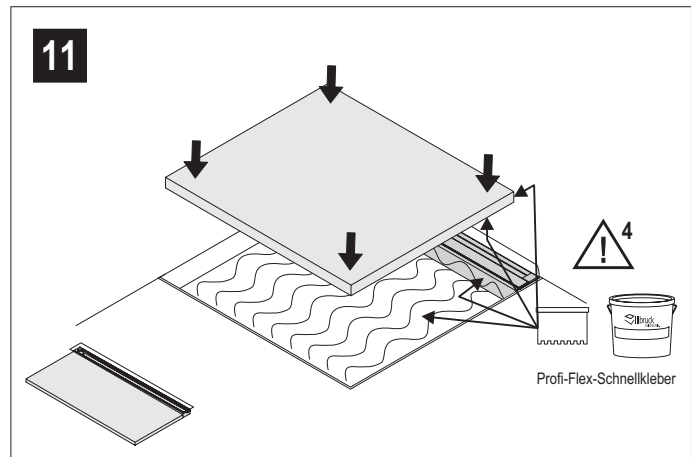
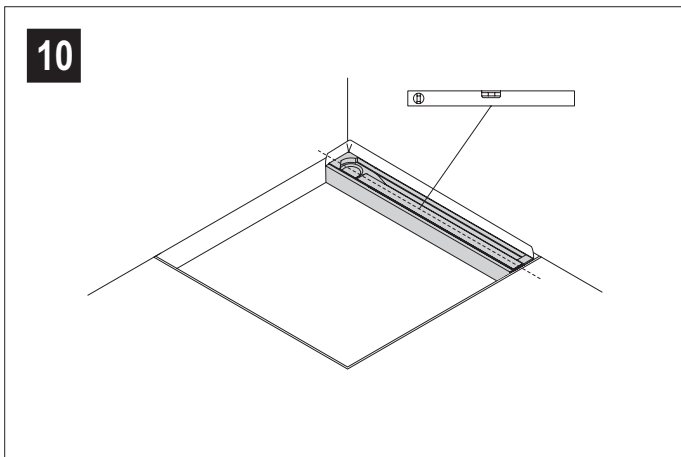

Einbauanleitung
Mounting instruction
Montagehandleiding
Instructions de montage
Istruzioni di montaggio

Poresta® Slot S

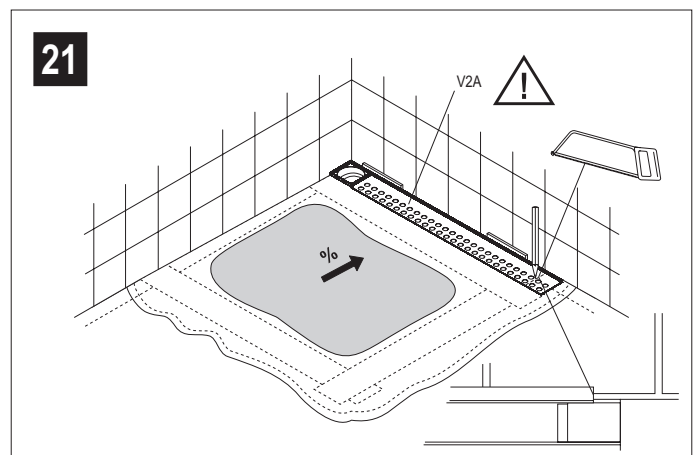
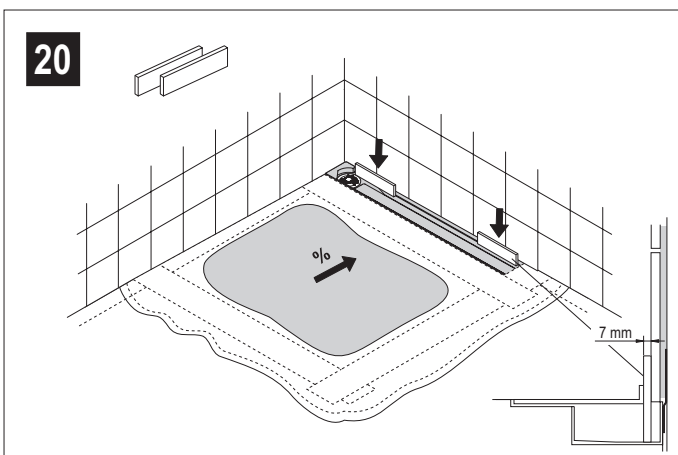
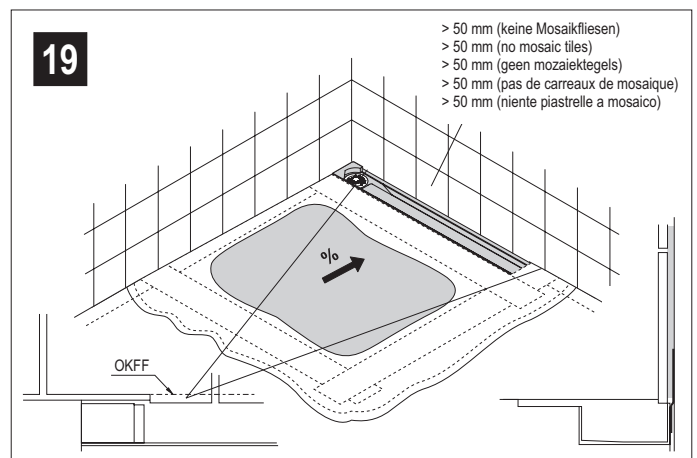
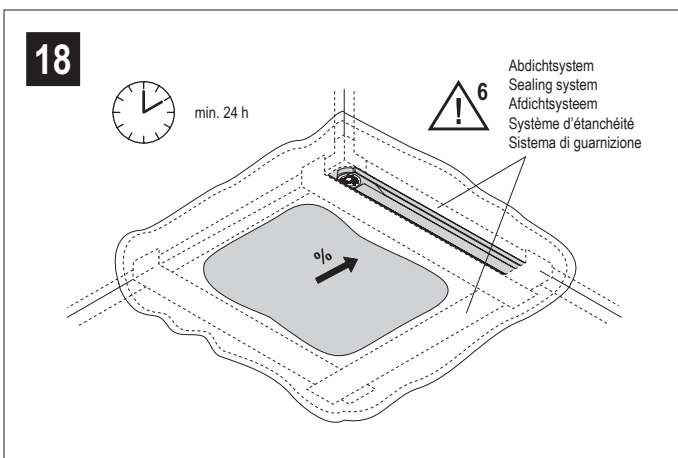
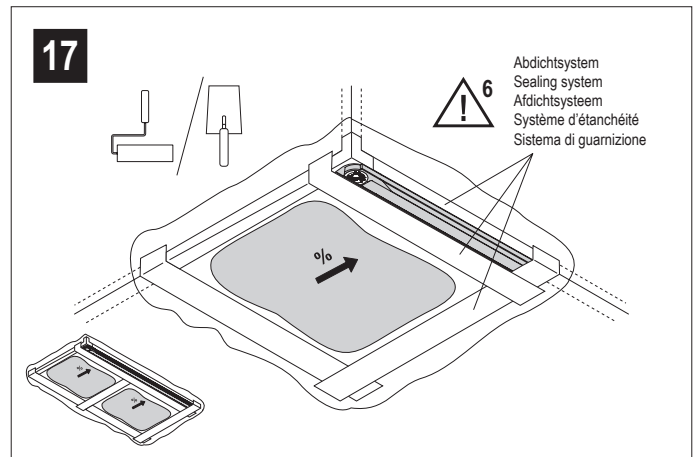
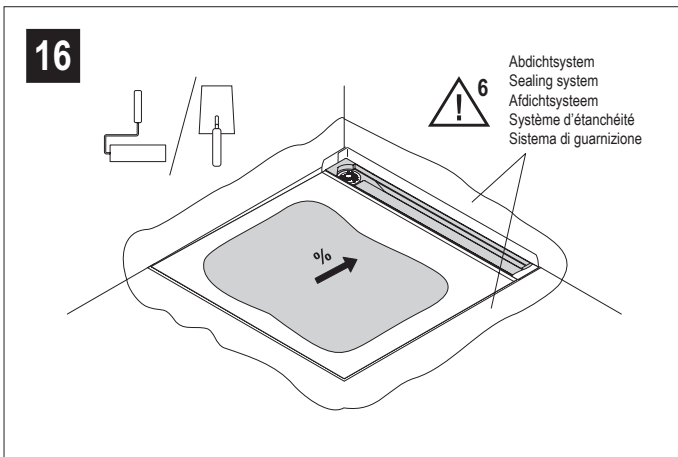

Einbauanleitung
 Mounting instruction
 Montagehandleiding
 Instructions de montage
 Istruzioni di montaggio

Poresta® Slot S

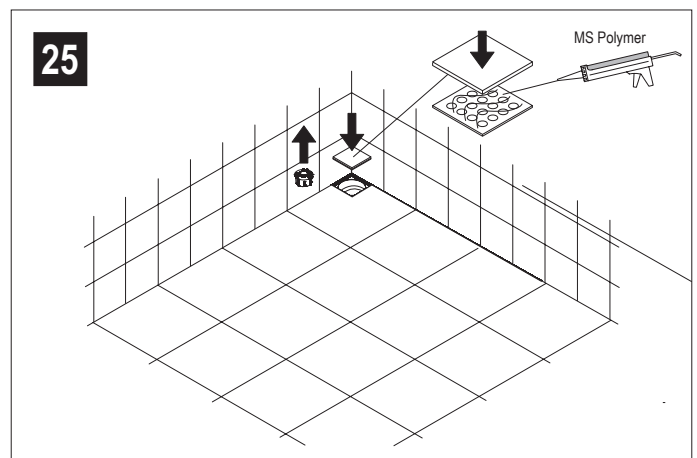
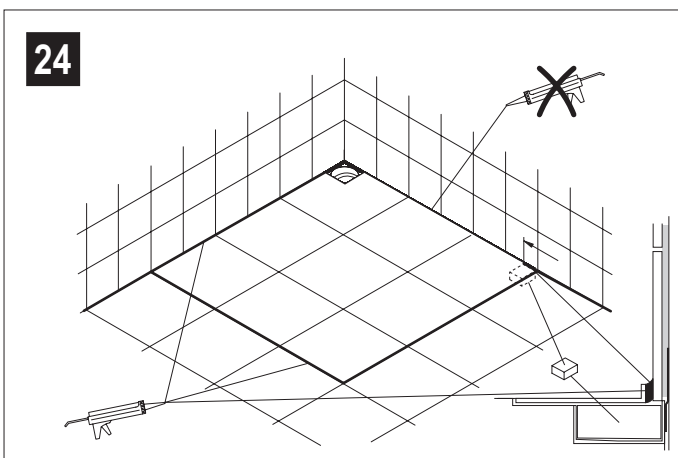
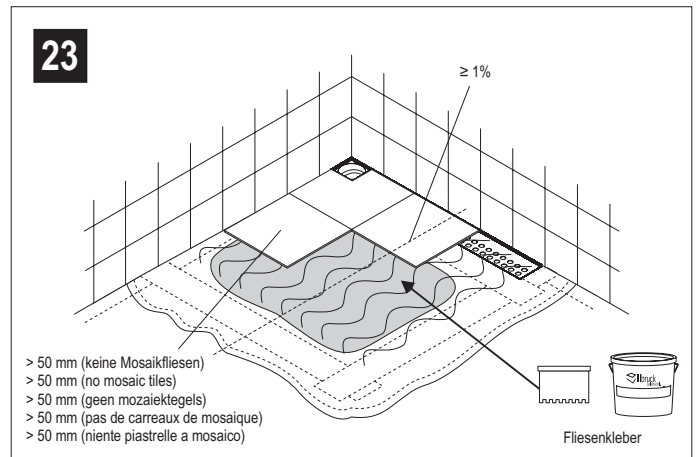
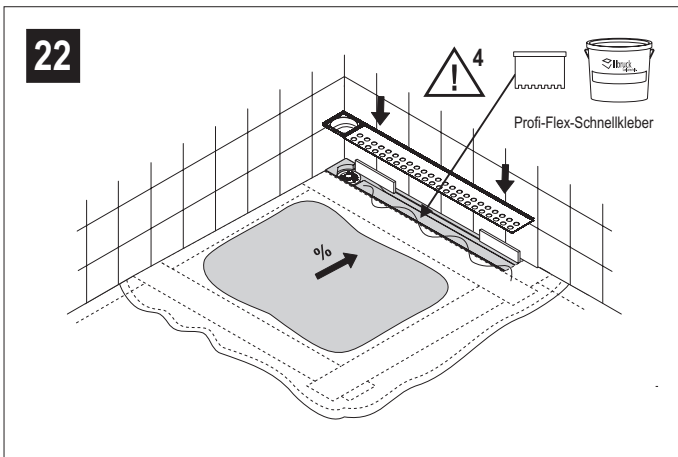

Einbauanleitung

Mounting instruction

Montagehandleiding







Instructions de montage

Istruzioni di montaggio

Poresta® Slot S

Verwendung:

- Das Duschsystem Poresta® Slot S kann seitens des Verarbeiters in Länge und Breite bis auf 500 x 700 mm gekürzt werden.
- Für den Einbau des Duschsystems muss ein ebener, sauberer, tragfähiger, schwingungsfreier und für die Verklebung mit Profi-Flex-Schnellkleber geeigneter Untergrund vorhanden sein.
- Das Duschsystem ist generell rollstuhlfahrbar unter Verwendung von Fliesen mit einer Mindestgröße 100 x 100 mm.
- Nur für den Einsatz im Innenbereich geeignet.







-  Die einschlägigen Verarbeitungsrichtlinien aller beteiligten Gewerke sind zu berücksichtigen.
-  **1** Beim Einbau (>110 mm / >65 mm) müssen Unterbauelemente (nicht im Lieferumfang) oder ein gegossener Estrichsockel verwendet werden. Die Höhe des Unterbauelementes/Estrichsockels ist anhand des Höhenunterschiedes zwischen Rohfußboden und Raumestrich zu wählen (siehe auch Einbaubeispiel).
-  **2** Randdämmstreifen sind bauseits zu stellen.
-  **3** Die Rinnenabschlussstopfen sind auch einzukleben, wenn das Duschelement nicht zugeschnitten wird.
-  **4** Fliesenkleber beidseitig auftragen.
-  **5** Nach Installation der Ablaufgarnitur ist eine Dichtigkeitsprüfung durchzuführen.
-  **6** Die Verarbeitungshinweise des Abdichtsystems Poresta® BF KMK sind zu beachten.

Einbaubeispiel mit Poresta® BF Unterbauelement:

Aufbauhöhe/Fertigfußboden	145 mm
Poresta® Slot S (waagerechter Ablauf)	- 105 mm
2 Lagen Fliesenkleber	-10 mm
<hr/>	
Poresta® BF Unterbauelement	= 30 mm

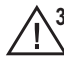
Use:

- The shower system Poresta® Slot S may be cut in length and width to 500 x 700 mm.
- For the installation of the shower system a level, clean, solid surface free of vibrations and suited for fastening with Profi-Flex fast tile adhesive must be available.
- The shower system is generally accessible for wheel chairs when using tiles of a minimum size of 100 x 100 mm.
- Suitable only for use indoor.

-  The relevant processing guidelines of all trades must be observed.
-  **1** For installation (>110 mm/>65 mm) substructure elements (not included in supply) or a cast screed base are to be used. The height of the substructure element/screed base is to be selected according to the difference in height between the raw floor and the room flooring (see also installation examples).
-  **2** Edge insulation strips are to be provided locally.
-  **3** The drain end plugs are to be cemented in position, even if the shower element is not cut to size.
-  **4** Apply tile adhesive to both sides
-  **5** After the installation of the drain fitting, a leakage test must be carried out.
-  **6** The processing instructions of the Poresta® BF KMK sealing system have to be observed.

Example for installation with Poresta® BF substructure element:

Mounting height/finished floor level	145 mm
Poresta® Slot S (horizontal drain)	- 105 mm
2 layers of tile adhesive	-10 mm
<hr/>	
Poresta® BF substructure element	= 30 mm

Einbauanleitung

Mounting instruction

Montagehandleiding

Instructions de montage

Istruzioni di montaggio

Poresta® Slot S

Toepassing:

- Het douchesysteem Poresta® Slot S kan door de monteur in lengte en breedte tot 500 x 700 mm worden ingekort.
- Voor de montage van het douchesysteem moet een vlakke, schone, draagkrachtige, trilvrije en voor verwerking van de Profi-Flex-snelplakker geschikte ondergrond aanwezig zijn.
- Het douchesysteem is in principe voor een rolstoel geschikt, als tegels met een minimale grootte van 100 x 100 mm worden toegepast.
- Alleen geschikt voor toepassing in binnenruimte.

 Met de betreffende verwerkingsrichtlijnen van alle betrokken onderdelen moet rekening worden gehouden.

 **1** Bij inbouwen (>110 mm/>65 mm) moeten de onderbouwelementen (niet in de levering inbegrepen) of een gegoten estrikkondergrond worden toegepast. De hoogte van het onderbouwelement/estrikkondergrond moet aan de hand van het hoogteverschil tussen onafgewerkte vloer en kamerestrik worden gekozen (zie ook installatievoorbeelden).

 **2** Randdichtingsstroken zijn niet in de levering inbegrepen.

 **3** De gootafsluiters moeten ook worden ingeplakt, als het douchelement niet wordt ingekort.

 **4** Tegelplakker aan beide kanten aanbrengen.

 **5** Na de installatie van de waterafvoer moet een dichtheidscontrole worden uitgevoerd.

 **6** De verwerkingsaanwijzingen van afdichtingssysteem Poresta® BF KMK moeten worden aangehouden.

Montagevoorbeeld met Poresta® BF onderbouwelement:

Opbouwhoogte/afgewerkte vloer	145 mm
Poresta® Slot S (horizontale afvoer)	- 105 mm
2 lagen tegelplakker	-10 mm
Poresta® BF onderbouwelement	= 30 mm

Utilisation:

- Le système de douche Poresta® Slot S peut être raccourci par l'installateur en longueur et en largeur jusqu'à 500 x 700 mm.
- Pour l'installation du système de douche, il est nécessaire de disposer d'une surface de base plane, propre, capable de porter le système, antivibratoire et appropriée à l'application de la colle rapide Profi-Flex.
- En général, le système de douche permet l'accès en fauteuil roulant à la condition de poser des carreaux d'une dimension minimale de 100 x 100 mm.
- Ne se prête qu'à l'installation à l'intérieur de bâtiments.

 Les directives correspondantes de mise en oeuvre de tous les métiers participants sont à observer.

 **1** Pour l'installation (>110 mm / >65 mm), il faut utiliser des éléments de support de base (pas compris dans la fourniture) ou un socle de chape coulée. Choisir la hauteur de l'élément de support de base/du socle de chape selon la différence de hauteur entre le sol brut et la chape de la salle (voir également les exemples d'installation).

 **2** Les bandes isolantes de bord sont à prévoir par le client.

 **3** Les bouchons de fermeture de la rigole sont à coller même si l'élément de douche n'est pas coupé sur mesure.

 **4** Appliquer de colle pour carreaux sur les deux faces.

 **5** Après installation de la garniture d'écoulement, procéder à un essai d'étanchéité.

 **6** Les directives de mise en oeuvre pour le système d'étanchéité Poresta® BF KMK sont à respecter.

Exemple d'installation avec élément de support de base Poresta® BF:

Hauteur de montage/sol fini	145 mm
Poresta® Slot S (conduite d'écoulement horizontale)	- 105 mm
2 couches de colle pour carreaux	-10 mm
Élément de support de base Poresta® BF	= 30 mm

Einbauanleitung Mounting instruction Montagehandleiding Instructions de montage Istruzioni di montaggio

Poresta® Slot S

Uso:

- Il sistema di doccia Poresta® Slot S può essere accorciato dall'installatore in lunghezza ed in larghezza fino a 500 x 700 mm.
- Per l'installazione del sistema doccia deve esistere un sottosuolo piano, pulito, solido, libero di vibrazioni e adatto per l'incollaggio per mezzo del collante rapido Profi-Flex.
- Il sistema doccia è generalmente accessibile con sedia a rotelle, se piastrelle di una grandezza minima di 100 x 100 mm sono usate.
- Adatto solo per l'uso interno.

 Si deve osservare le istruzioni di lavorazione di tutti i mestieri partecipanti.

 1 Per l'installazione (>110 mm / >65 mm) gli elementi di spessore (non compresi nella consistenza di fornitura) o uno zoccolo di pavimento continuo devono essere usati. L'altezza dell'elemento di spessore/dello zoccolo di pavimento deve essere scelta secondo la differenza d'altezza tra fondo grezzo e pavimento camera (vedi anche esempi d'installazione).

 2 Fasce isolanti di bordo devono essere messe a disposizione localmente.

 3 I tappi di chiusura del condotto devono essere incollati anche se l'elemento di doccia non è tagliato su misura.

 4 Applicare l'adesivo per piastrelle su entrambi i lati.

 5 Dopo l'installazione dell'elemento di scarico, si deve procedere ad una prova d'ermeticità.

 6 Si deve osservare le istruzioni di lavorazione per il sistema di guarnizione Poresta® BF KMK.

Esempio d'installazione con elemento di spessore Poresta® BF:

Altezza di montaggio/ pavimento finito	145 mm
Poresta® Slot S (scarico orizzontale)	- 105 mm
N. 2 strati di collante per piastrelle	-10 mm
Elemento di spessore Poresta® BF	= 30 mm

Empfohlenes Zubehör / Recommended accessories / Aanbevolen toebehoren / Accessoires recommandés / Accessori raccomandati:



illbruck Profi-Flex-Schnellkleber / Profi-Flex fast-setting adhesive / Profi-Flex-snelplakker / Colle rapide Profi-Flex / Collante rapido Profi-Flex



illbruck Abdichtsystem Poresta® BF KMK / Sealing system / Afdichtstysteem / Système d'étanchéité / Sistema di guarnizione

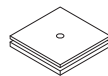

Poresta® BF Unterbauelement / Substrate element / Onderbouwelement / Élément de support de base / Elemento di supporto di base



Poresta® BF Dichtband / Sealing tape / Afdichtingsband / Bande isolante / Fascia isolante



Poresta® BF Dichtband-Innenecke / Sealing tape interior corner / Afdichtingsband-binnenliggende hoek / Bande isolante pour coin intérieur / Fascia isolante per angolo interno

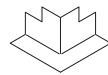

Poresta® BF Dichtband-Außenecke / Sealing tape exterior corner / Afdichtingsband-buitenliggende hoek / Bande isolante pour coin extérieur / Fascia isolante per angolo esterno



Geeigneter Fliesenkleber / Suitable tile adhesive / Geschikte tegelplakker / Colle appropriée pour carreaux / Collante per piastrelle adatto



Silikon / Silicone / Siliconen / Silicone / Silicone



Reinigungsbürste / Reinigingsborstel / Brosse de nettoyage / Cleaning brush